

Installation Guide

PERLATO

Perlato Profilo Rectangle Mirrors

IMPORTANT

Before beginning installation, make sure that the mirror is the correct model and size and conduct a thorough inspection.

1. Measure distance between bracket holes on rear of mirror in desired orientation.

Mark wall appropriately.

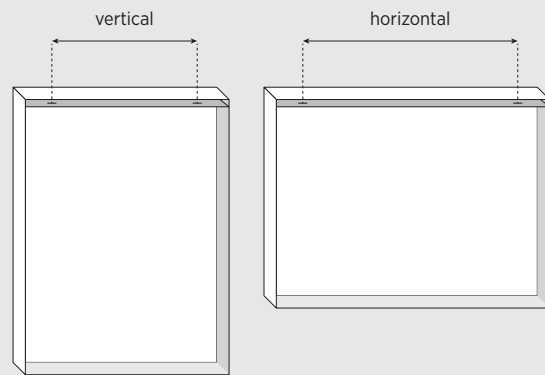

2. Drill mounting holes in wall and fasten wall brackets with screws.

Ensure brackets will be anchored to wall studs or reinforce wall for support.

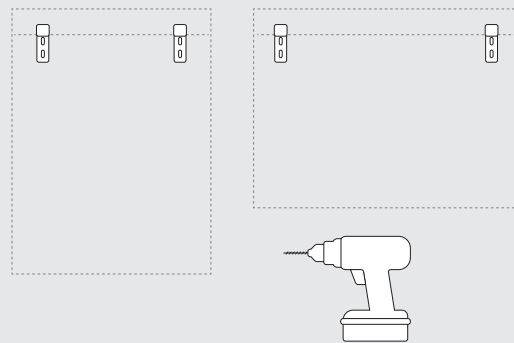

3. Hook mirror onto wall brackets.

